

TP-DE 21086

N°	Code	Description	QTY
1	TP-CA174	Side Cover (CE 18651)	1
2	TP-CA106	Nut - M25 x 1,5 (CE30210)	1
3	TP-40M 7216	Seguer 52 I	1
4	TP-CA126	Bearing - 3205 A-2RS1 (DE19311)	1
5	TP-N 10145	Grease fitting 1/4" x 28	2
6	TP-DE 21086-C	Gearbox case	1
7	TP-CA124	Bearing 6209-2RS (DE19306)	1
8	TP-DE 30587-P1	Pinion Z19	1
9	TP-CE 18663	Nut - M30 x 1,5	1
10	TP-CE 19573	Top cover	1
11	TP-CE 20069	Washer	1
12	TP-CE 18307	Threaded cap	1
13	TP-AE 38448	Breather 1/8" GASS	1
14	TP-CE 19565	Shaft	1
15	TP-P 50635	O -ring	1
16	TP-DE 30587-P2	Pinion Z19	1
17	TP-CA125	Bearing 6210 (JD9346)	1
18	TP-DE 30099	Seal - SAV 6849 50-90-8	1
19	TP-CE 19249A	Hub (High support)	1
20	TP-CE 19249R	Flywheel / Counterweight	1
21		Bolt - M10 x 1,50 x 25L	6
22	TP-CE 19586	Nut - M36 x 1,5	1
23	TP-CE 19587	Key - 10 x 8 x 90	1
24	TP-CE 19572	Ring gear - Z42	1
25	TP-CE 18661	Hex bolt - 8 x 20	4
26	TP-AZ 51954	Bearing - 6021-2RS1	1
27	TP-DE 30033	Seal - 165 x 140 x 10	1
28	TP-CE 18665	Key - 10 x 8 x 28	1
29	TP-DE 21086-E	Eccentric shaft	1
30	TP-JD 38925	Needle roller bearing HK 3020	1
31	TP-CE 19588	Bushing IR25X30X20	1
32	TP-40M 7066	Seguer 55A	1
33	TP-DE 19907	Bearing 3211 A-2RS1/MT33	1
34	TP-CE 19568	Bottom cover	1
35	TP-19M 9419	Hex bolt - 10 x 1,25 x 25	3
36	TP-DE 19906	Seal - 100 x 90 x 7 DL	1
37	TP-CE 19571	Pinion shaft Z21	1
38	TP-AXE 24816	Drive bloc / Actuator	1
39	TP-19M 7813	Bolt - M12 x 45	2



TP-DE 21086 KNIFE DRIVE

STROKE: 4 INCHES
WEIGHT: 60,00 KG

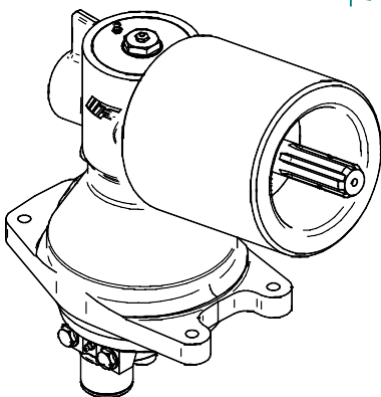
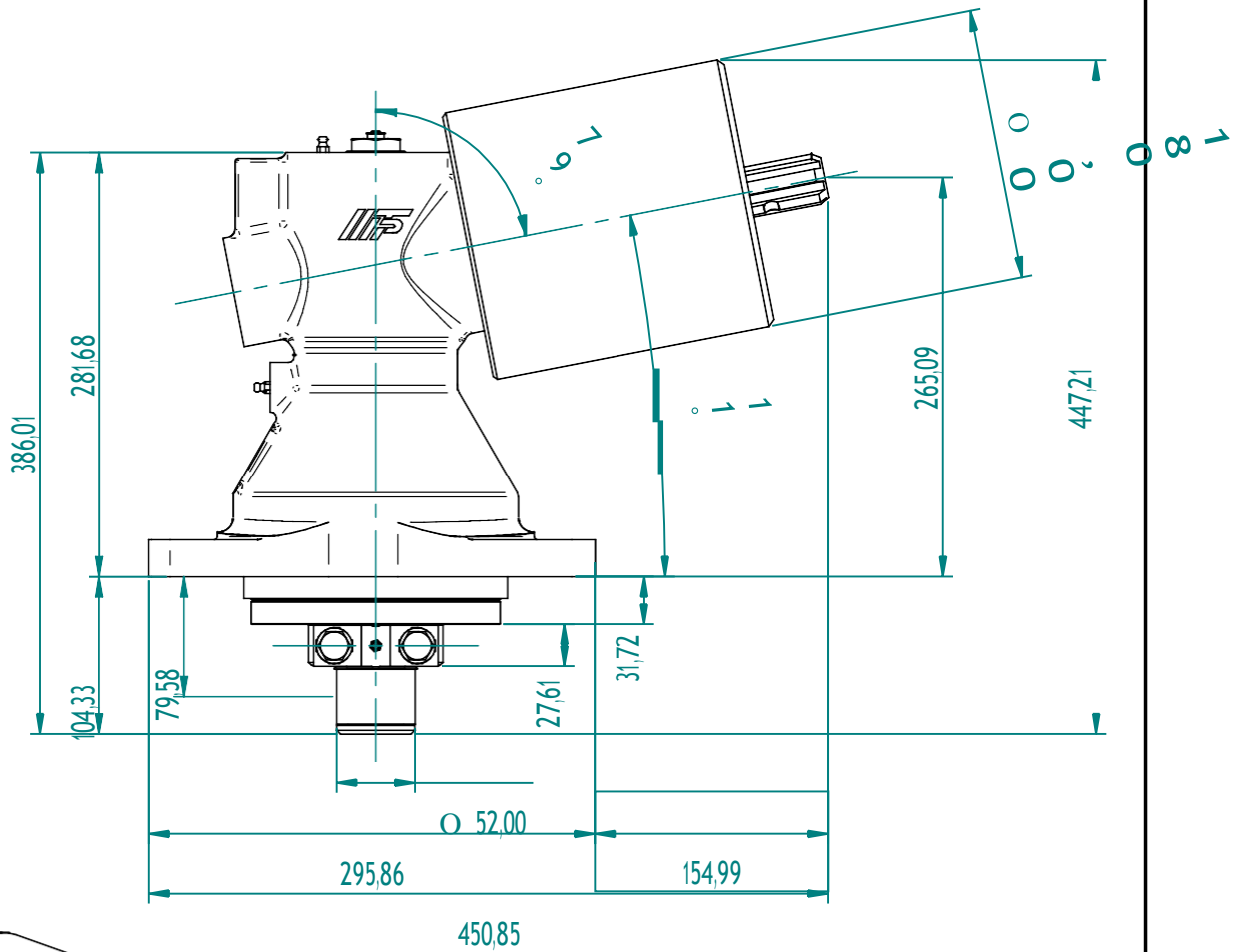
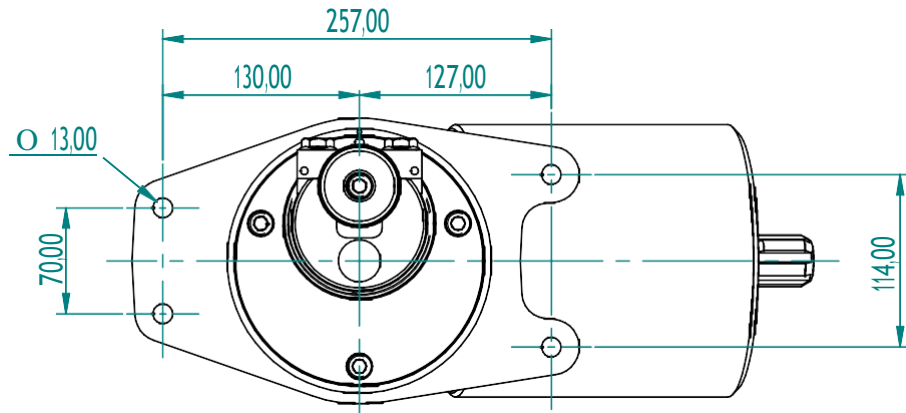

Installation procedure

TP-DE 21086

In order to properly install the TP-DE21086 knife drive in JD draper the cutting bar / knives must be synchronized.

Move the actuator / drive block in the maximum travel position as shown on the image below. Repeat on the other side of the header

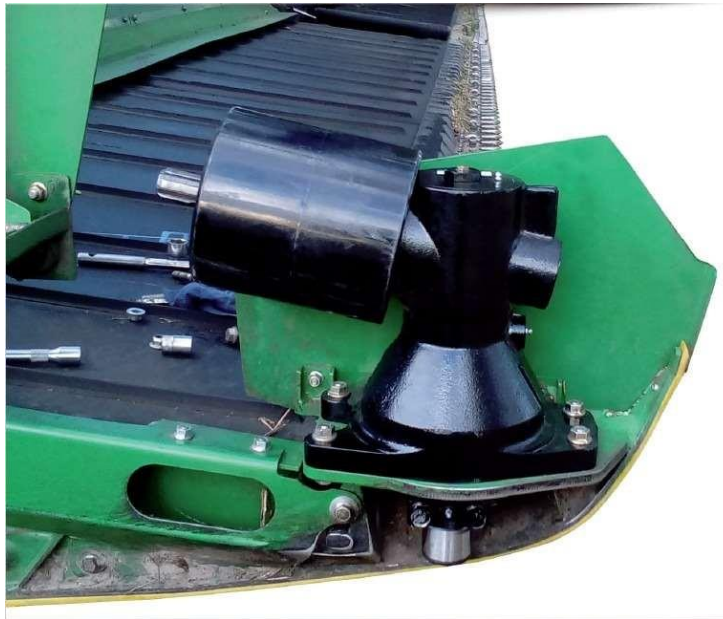

Fit the cardan shaft flange in the DE21086 input shaft just in the the travel position that was set. If cannot mount the flange on the shaft, disassemble the cardan shaft from the other end and spin the cardan until the flange fits the gearbox shaft.

Fasten the bolts

We recommend that at each beginning of harvesting to check the adjustment of the flywheel nut. Remove it, clean, and re-thread using Loctite red series (maximum torque) or some good quality anaerobic.

KNIFE DRIVE TP-DE 21086



FLYWHEEL-COUNTERWEIGHT DESIGN UPDATE-IMPROVEMENT

Due to occasional problems with the adjustment of the original flywheel, Tecnología Perez has re-designed and introduced an upgraded flywheel that uses a bolted SAE1045 steel hub for increased reliability / fastening and a more robust overall product.

Original flywheel / counterweight design

TP-CE 19249 (flywheel) / TP-CE 19586 (nut)



Upgrade – New flywheel design

TP-CE 19249A / TP-CE 19249R / TP-CE 19586R

